

BUILD TO SUIT

BUILD TO SUIT FOR INDUSTRIAL PLANT UP TO 100,000 SQ FT.

LOCATION: 5000 Regal
CATEGORY: Build To Suit
SIZE: 6.4 Acres

- South of Moynahan St. in the Delduca Industrial Park
- Vacant 6.4 acre industrial land zoned M1
- Industrial building of up to 100,000 Sq Ft can be built
- Build to suit and Leaseback available
- See concept site plan attached

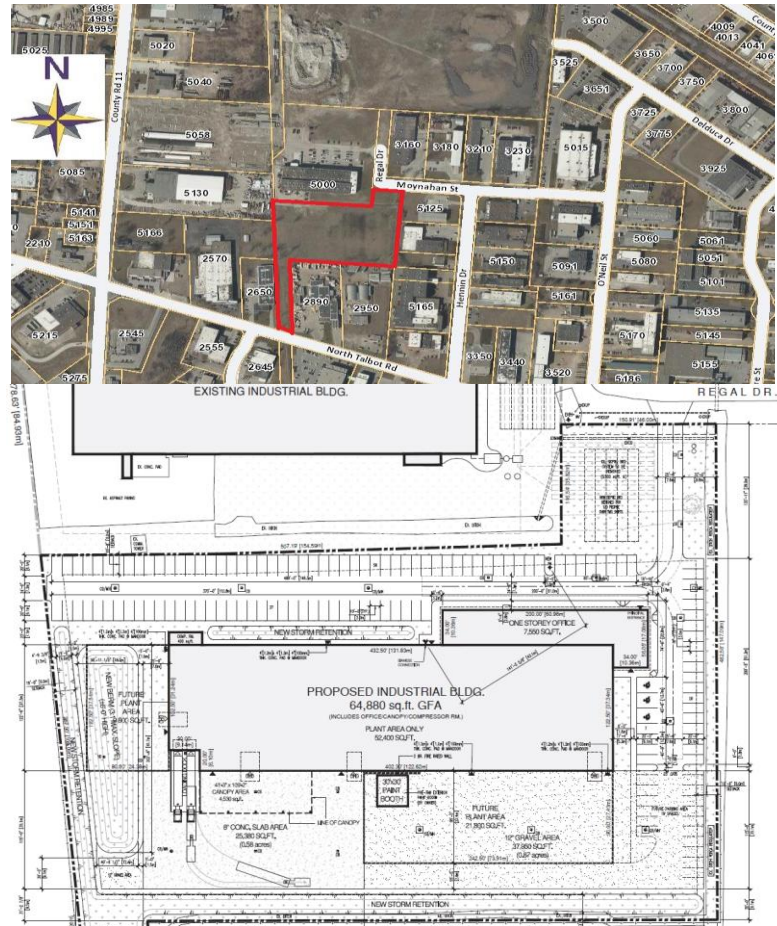

Design Concept

For More Information Please contact:

Tony Rosati
Tony.Rosati@rosatigroup.com
c: 519-796-6537
o: 519-734-6511

Nick Rosati
Nick.Rosati@rosatigroup.com
c: 519-796-6521
o: 519-734-6511

ROSATI
DEVELOP • DESIGN • CONSTRUCT

#buildonexperience



ROSATIGROUP.COM